





£875,000



Features

- Superb Detached Executive Home
- High Quality Contemporary Finish Throughout
- Generous Private Corner Plot
- In and Out Driveway Plus Detached Double Garage
- Five Spacious Bedrooms
- Convenient and Sought After Location
- Stunning Living Dining Kitchen With Island and Bi-fold Doors

Standing in a generous corner plot with immaculate, private grounds, a stunning, five double bedroom, detached executive home. Updated and improved in recent times, this beautiful dormer bungalow offers versatile, comfortable living over two floors with the highest of finishes.

Perfect for many types of buyer with light, bright and airy accommodation coupled with an 'In and Out' driveway to the front and a separate, gated rear drive leading to the detached double garage. Convenient, sought after location comprising: entrance hall, living room with media wall, living dining kitchen with island and bifold doors, conservatory, utility room, two ground floor bedrooms, luxury bathroom, three first floor bedrooms with two dressing rooms and a second bathroom. Viewing highly recommended



Windlehurst Road is a popular location with its convenience for both the city commute and access to the open countryside. High Lane has an array of shops, pubs and restaurants, including doctors and pharmacy. It has two fantastic primary schools and some great walks nearby, the Middlewood Way and Macclesfield Canal are extremely popular. Excellent transport links including the railway station on the Manchester Piccadilly line and A555 bypass.



Windlehurst Road, High Lane
 Total Approx. Floor Area 3538 Sq.ft. (328.7 Sq.M.)

Surveyed and drawn by Lens Media for illustrative purposes only. Not to scale. Whilst every attempt was made to ensure the accuracy of the floor plan, all measurements are approximate and no responsibility is taken for any error.

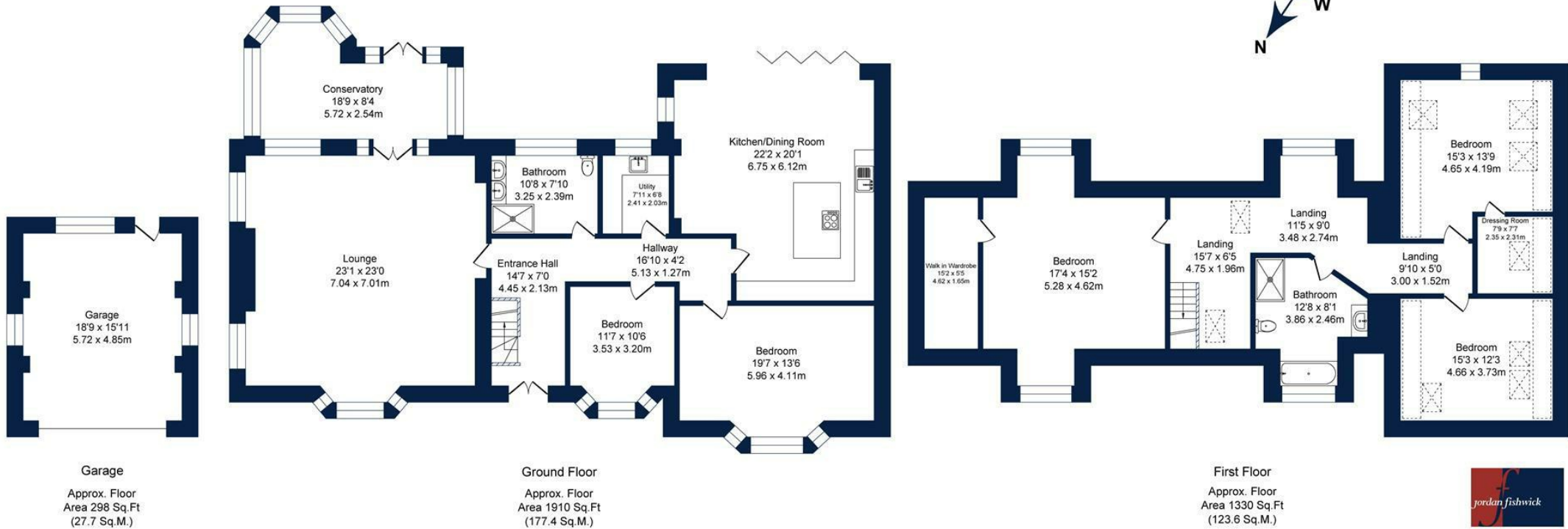



IMPORTANT: we would like to inform prospective purchasers that these sales particulars have been prepared as a general guide only. A detailed survey has not been carried out, nor the services, appliances and fittings tested. Room sizes should not be relied upon for furnishing purposes and are approximate. If floor plans are included, they are for guidance only and illustration purposes only and may not be to scale. If there are any important matters likely to affect your decision to buy, please contact us before viewing the property.



JORDAN FISHWICK
EXCLUSIVE

Jordan Fishwick
14 Market Street, Disley, Cheshire, SK12 2AA
01663 76 78 78
disley@jordanfishwick.co.uk